

RWI – Leibniz Institute for Economic Research is a leading center for economic research and evidence-based policy advice in Germany and is financed primarily by federal and state funds. The Institute's work provides information on economic developments and their causes, facilitates informed decision-making by policymakers and businesses, and promotes public understanding of economic interrelationships. In the department Climate Change and Development, RWI works in close cooperation with African governments and international organizations such as the World Bank, the ILO, the GIZ, or 3ie on research projects, especially on labor market, migration, environmental issues, and meta-science.

RWI invites applications for several positions of

Student research assistants (m/f/d)

to support the team of researchers of the research unit **Climate Change and Development** in the topic areas **Meta-Science** and **Research Transparency**. The successful applicant will work on the DFG funded project "Robustness and Replicability in Economics". In this project, we aim to define replicability for non-experimental studies in economics and conduct many replications using the original data of the studies. The project contributes to the ongoing debate about the robustness of empirical findings in economics.

Your tasks will include

- collecting accessible data online
- background and literature research
- analyzing the debates around important economics papers and check their replicability
- going through a large body of literature and extracting information
- cleaning and processing of data collected by RWI or from other sources
- support for data analysis and reporting for empirical research projects

Successful applicants should

- be interested in the topics of meta-science and research transparency
- have completed or be currently enrolled in a degree in economics, statistics, computer sciences, development studies or a related field
- have an excellent command of English and strong writing skills; German is not required
- having advanced knowledge of the statistical software Stata is a plus
- knowledge of R and/or Python is a plus

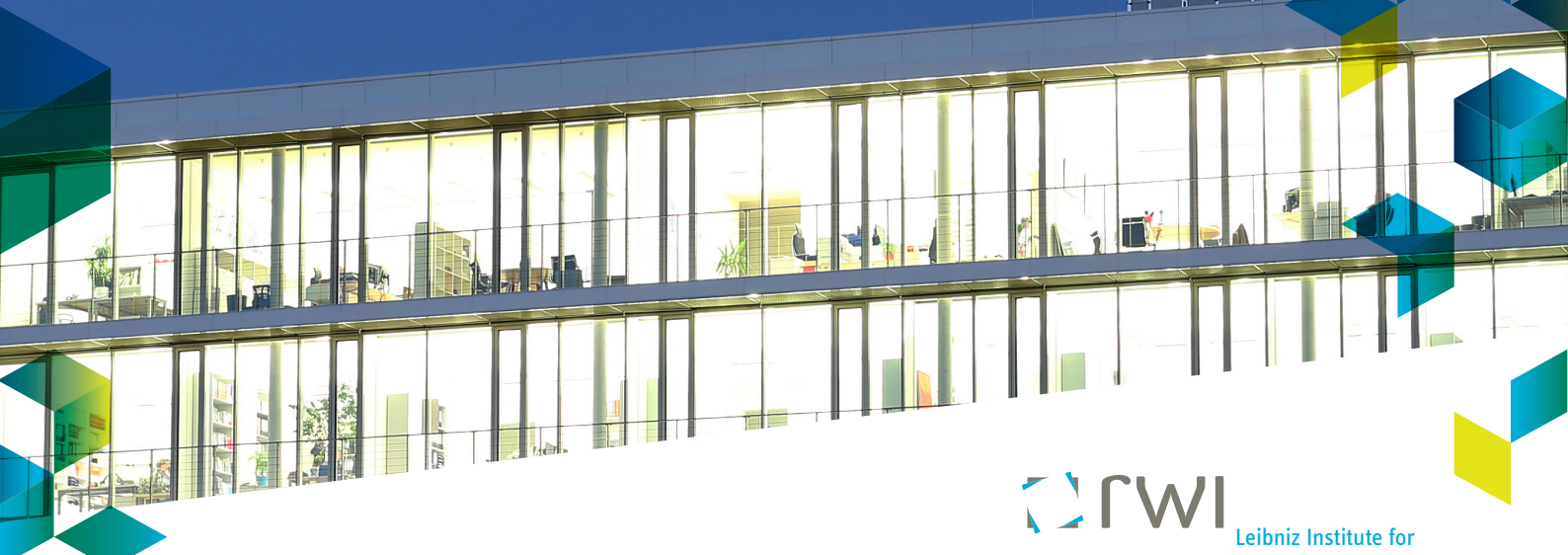

The position starts as soon as possible and is limited to six months with the possibility of extension. The minimum weekly working time is 8 hours. The work should be mostly done in the office (Essen or Berlin).

Compliance with the guidelines for the severely disabled and the provisions of the law on part-time work is ensured. We promote professional equality for all genders- For further information on the position, please contact Florian Neubauer. For further information on the application process, please contact Mr. Tilo Schneider. Both can be reached at personal@rwi-essen.de.

Please send your application documents (cover letter, curriculum vitae, references), preferably by e-mail, quoting the **reference number 70900-28/22SHK** until **November 30th, 2022**.

RWI – Leibniz-Institut für Wirtschaftsforschung
Mr. Tilo Schneider
P.O. Box 10 30 54, 45030 Essen, Germany
humanresources@rwi-essen.de

For more information on the Institute, please visit <https://www.rwi-essen.de/en/>

When sending your application by e-mail, please note that this method of transmission does not encrypt your data and could possibly be accessed or falsified by unauthorized persons. You are welcome to send us your documents by mail.

Essen, November 2, 2022